

**Master GM-72-031 1/72 17pdr SP M10 "Achilles" - lufa działa QF 17pdr (76.2mm)****Cena :****23,20 PLN**Producent : **MASTER**Dostępność : **Na zamówienie (Oczekiwanie: 7~14 dni)**Stan magazynowy : **bardzo wysoki**Średnia ocena : **brak recenzji****On individual order****Master GM-72-031 1/72 17pdr SP M10 "Achilles" - lufa działa QF 17pdr (76.2mm)**

Wysokiej jakości toczone, metalowe elementy do modeli w skali 1/72

Producent: **MASTER** (Polska)**Polecamy!**

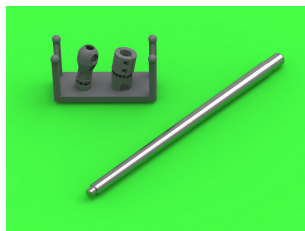

**1:72**  
GROUND MASTER SERIES  
**GM-72-031**

**17PDR SP M10**  
**ACHILLES**  
QF 17PDR (76.2MM) GUN BARREL  
M10 ACHILLES - LUFA DZIAŁA QF 17PDR

**SET INCLUDES**  
ZESTAW ZAWIERA

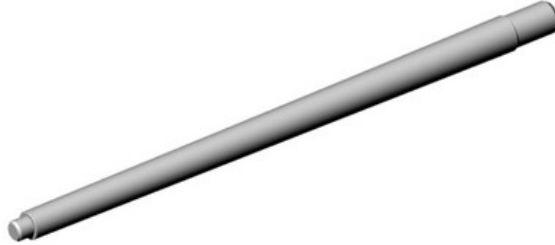
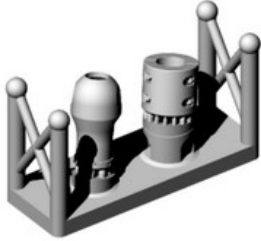

**INSTRUCTION**  
INSTRUKCJA

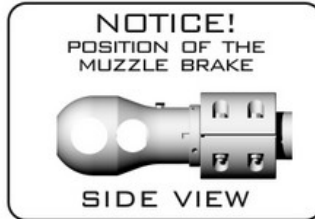
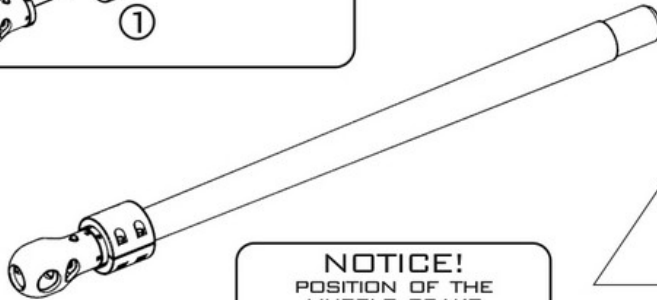
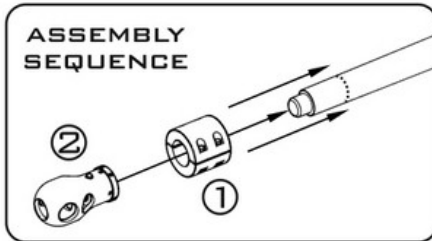

PREPARE THE HOLE  
IN THE MANTLET  
IF NEEDED

$\Phi$  1,9MM



(DIRECT FIT TO  
UNIMODELS KIT)

INSERT THE METAL PART USING CYANOACRYLATE ADHESIVES  
WKLEJ METALOWY ELEMENT, UŻYWAJĄC KLEJU CYJANOAKRYLOWEGO

**RELATED MASTER SETS:**

GM-72-030 - M10 - 3-INCH (76.2 MM) GUN BARREL

**MASTER**

WWW.MASTER-MODEL.PL  
©COPYRIGHT 2024, MASTER - PIOTR CZERKASOW  
DESIGNED AND PRODUCED IN POLAND